

LOUDSPEAKERS 110-120 SERIES

Marine/Industrial and
Hazardous Area Loudspeakers

EXPLOSION-PROOF SERIES

- **8 Watt, 110dB output**
- **15 Watt, 116dB output**
- **25 Watt, 123dB output**
- **Approved for Zone 1 IIB and IIC**
- **CE Compliant**
- **ATEX certified**
- **Intelligent speaker monitoring & remote tapping (I.S.M.T.)**
- **IEC Certified (25 W versions)**

COMMON FEATURES

Watertight to IP66/IP67

Corrosion resistant

Stainless steel bracket

Dual entry and short horn versions

Interface with wide range of systems

100 or 70 volt line (options)

Low impedance 8 Ohm (option)

APPLICATIONS

Zone 1 hazardous areas

Oil, gas and petrochemical industries

Marine (ships, offshore rigs)

Public Address/General Alarm (PA/GA)

Arduous industrial environments

The success of the 110-120 Series of loudspeakers comes from their robust corrosion resistant body combined with highly intelligible audio output. These loudspeakers are highly recommended for indoor and outdoor use in either hazardous or safe areas. The loudspeakers are supplied standard with stainless steel hardware and corrosion resistant powder coat paint.



MARINE/INDUSTRIAL SERIES

- **8 Watt, 114dB output**
- **15 Watt, 118dB output**
- **25 Watt, 125dB output**
- **CE Compliant**
- **Intelligent speaker monitoring & remote tapping (I.S.M.T.)**

ATEX



CE

tel: UK +44-(0)1625-666600 • USA +1-877-289-3246
www.fs-isys.com

FEDERAL SIGNAL CORPORATION
Integrated Systems

EXPLOSION-PROOF LOUDSPEAKERS SPECIFICATIONS

Type:	8/15/25 Watt dual entry
Gland entries:	2xM20 x 1.5mm 1 Exd Stopping Plug
Cable Terminations:	6A, 1.5mm ² conductors
Mounting:	Stainless steel bracket (not painted)
Material:	Body & Horn—Marine Grade Aluminum Alloy
Audio Lines:	100 Volt 70 Volt 8 ohms
Frequency Range:	110 Series 8W 600–4000 Hz 110 Series 15W 390–4500 Hz 120 Series 25W 350–4000 Hz
Dispersion angle:	Short Horn Series 180° Standard Horn Series 120° 120 Series 25W 120°
Ambient Temperature Range:	–20°C to +40°C · T6 –20°C to +55°C · T5 –20°C to +70°C · T4

Net Weight:	
8W Short Horn Series	3.0kg (6.6 lbs)
15W Series	3.2kg (7.1 lbs)
25W Series	6.4kg (14.1 lbs)

Shipping Dimensions:	
29 x 29 x 30 cm (8W/15W)	
32 x 30 x 38 cm (25W)	

Sound Pressure Level:
SPL@1kHz Full power @ 1 meter

8W-IIB	8W-IIC	15W-IIB	15W-IIC	25W-IIB
110dB	106dB	116dB	112dB	123dB

SPL@1kHz (1 watt @ 1 meter)

8W-IIB	8W-IIC	15W-IIB	15W-IIC	25W-IIB
101dB	101dB	104dB	104dB	107dB

Certification and Approval 110 Series–8 and 15 Watt

Baseefa 03ATEX0688X

⊕ II2G EExdIIBT4...T6
EExdeIIBT4...T6

Baseefa 03ATEX0689X

⊕ II2G EExdIICT4...T6
EExdeIICT4...T6

120 Series–25 Watt

Nemko 05ATEX1036
IEC

⊕ II2G EExd IIBT4 ...T6
IEC ExNMO4.0002

Standards

EN50014:1997 + A1:1999 + A2 :1999
EN50018:2000 + A1, EN500019:2000
CE

EMC to EN 61000-6-1,2,3,4:2001

LVD to EN 60065

Ingress Protection

8W/15W

IP66 & IP67-EN60529

25W

IP66 & IP67-EN60529

MARINE LOUDSPEAKERS SPECIFICATIONS

Type:	8/15/25 Watt dual entry
Gland entries:	2xM20 x 1.5mm
Cable Terminations:	6A, 1.5mm ² conductors
Mounting:	Stainless steel bracket (not painted)
Material:	Body & Horn—Marine Grade Aluminum Alloy
Audio Lines:	100 Volt 70 Volt 8 ohms
Frequency Range:	110 Series 8W 500–8000 Hz 110 Series 15W 390–8500 Hz 120 Series 25W 300–3700 Hz
Dispersion angle:	Short Horn Series 180° Standard Horn Series 120° 120 Series 25W 120°
Ambient Temperature Range:	–20°C to +70°C

Net Weight:	
8W Short Horn Series	3.0kg (6.6 lbs)
15W Series	3.2kg (7.1 lbs)
25W Series	6.4kg (14.1 lbs)

Shipping Dimensions:	
29 x 29 x 30 cm (8W/15W)	
32 x 30 x 38 cm (25W)	

Rated Power:	8W	15W	25W
SPL@1kHz (@ full power)	114dB	118dB	125dB
SPL@1kHz (@ 1 Watt)	104dB	106dB	107dB

Certification

Electromagnetic compatibility to EN 61000-6-1,2,3,4: 2001

Ingress Protection

to IP66 & IP67-EN60529

*Marine Loudspeakers are not ATEX-Certified



Warning: All units are not certified for use in flammable atmospheres containing: carbon disulphide or ethyl nitrate.
(Explosion-proof series only)

TRANSFORMER TAPPINGS

Output transformers have high and low range tapings providing full output flexibility.

8 Watt	High range tapping	1.0–2.0–3.0–5.0–8.0
15 Watt		2.0–5.0–7.0–10.0–15.0
25 Watt		5.0–10.0–15.0–20.0–25.0
	Low range tapping	0.05–0.1–0.2–0.3–0.5
8 Watt		0.1–0.3–0.5–0.7–1.0
15 Watt		0.2–0.6–1.0–1.5–2.0
25 Watt		

DIMENSIONS

110 SERIES—8 WATT SHORT HORN (MODEL 114)

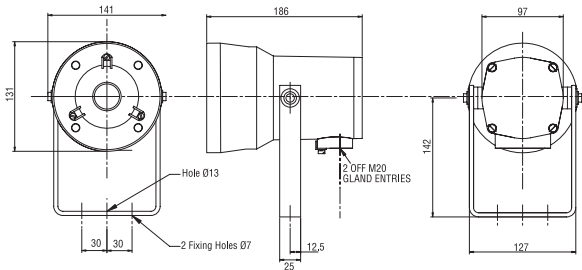

110 SERIES—15 WATT STANDARD HORN (MODEL 110)

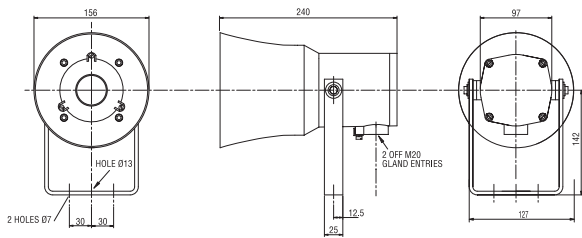

120 SERIES—25 WATT STANDARD HORN (MODEL 120)

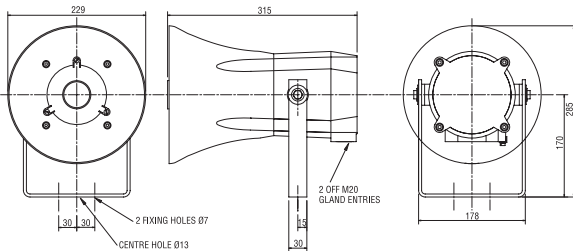

Note: All dimensions are in millimeters.

ORDERING CHARTS

8W and 15W Loudspeakers:

Type	15 Watt Standard–Dual Entry	110
	8 Watt Short Horn–Dual Entry	114

Protection	Marine	1
	EExd IIB	7
	EExd IIC	2

Rating	8 Ohms	1
	70V	4
	100V	5

Special Features	None	0
	Intelligent Speaker Monitoring & (Remote) Tapping (I.S.M.T.)*	4
	Special Variation	5
	Ceiling Grill Kit	C

*100VRMS Versions Only

25W Loudspeakers:

Type	25 Watt Standard Horn–Dual Entry	120
------	----------------------------------	-----

Protection	Marine	1
	EExd IIB	7

Rating	8 Ohms	1
	70V	4
	100V	5

Special Features	None	0
	Intelligent Speaker Monitoring & (Remote) Tapping (I.S.M.T.)*	4
	Special Variation	5

*100 VRMS Versions Only

110 7 5 0

120 7 1 0

Solutions for Life Safety, Communication, and Security.

Federal Signal Integrated Systems is the world's leading supplier of communication and security equipment for industrial and marine applications. Integrated Systems will assess your needs and provide a solution—no matter how harsh the environment.

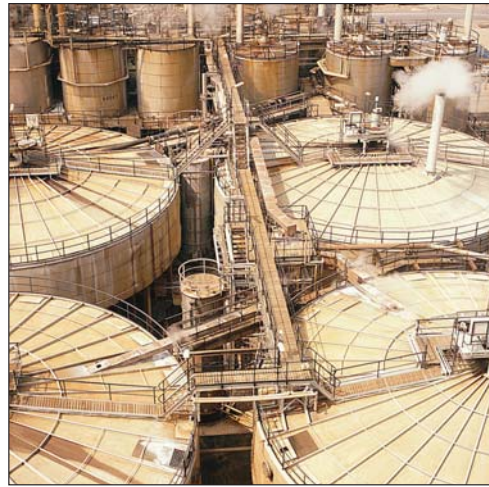

UK - Federal Signal Corporation, Integrated Systems

Hulley Road, Hurdsfield Industrial Estate,
Macclesfield, Cheshire SK10 2NF, UK

tel: +44 (0)1625 66 66 00 **fax:** +44 (0) 1625 611 352

web: www.fs-isys.com **email:** systems@fedsig.co.uk

USA - Federal Signal Corporation, Integrated Systems

2645 Federal Signal Drive, University Park, IL 60466, USA

tel: +1 708-534-4723 **fax:** +1 708-534-4887

web: www.fs-isys.com **email:** systems@fedsig.com

ATEX



FEDERAL SIGNAL CORPORATION
Integrated Systems